

MAP OF DOWNTOWN PHILADELPHIA

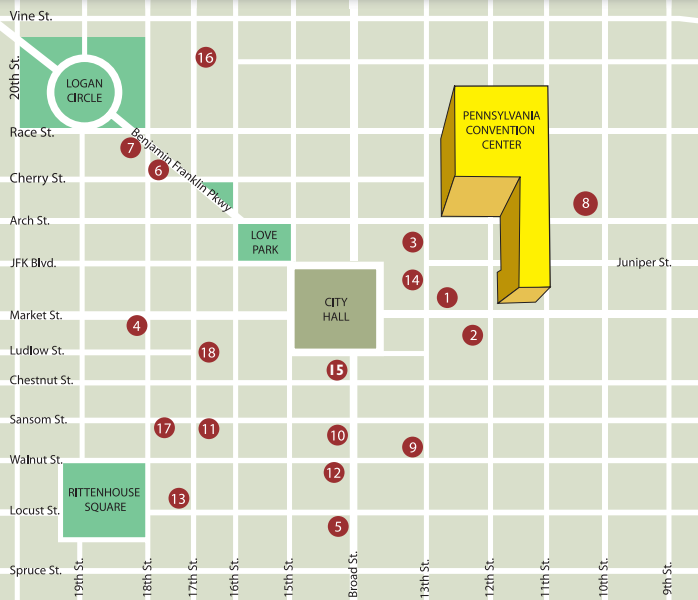

Convention Guide

Hotels

- | | |
|---|---|
| 1 Philadelphia Marriott (NS) | 11 Latham Hotel |
| 2 Loews Philadelphia | 12 Park Hyatt Philadelphia at the Bellevue |
| 3 Courtyard by Marriott (NS) | 13 Radisson Plaza–Warwick Hotel |
| 4 Crowne Plaza Hotel | 14 Residence Inn by Marriott Philadelphia (NS) |
| 5 Doubletree Philadelphia | 15 Ritz Carlton Philadelphia (NS) |
| 6 Embassy Suites Hotel Center City | 16 Sheraton Philadelphia City Center |
| 7 Four Seasons Hotel Philadelphia | 17 Sofitel Philadelphia |
| 8 Hilton Garden Inn | 18 Westin Hotel (NS) |
| 9 Holiday Inn Express | |
| 10 Inn at the Union League | |



Philadelphia 2006



Convention Locations

Most English sessions and child care are in the Philadelphia Marriott. Most foreign language and comparative literature sessions are in the Loews Philadelphia. Some English sessions, some foreign language sessions, some comparative literature sessions, exhibits, and Job Information Center are in the Pennsylvania Convention Center.

BADGES

Plastic badge holders are available at the MLA registration and information centers.

BUSINESS CENTERS

Philadelphia Marriott, Fed Ex-Kinko's, lobby level

Hours: 24 hours a day

Loews Philadelphia Business Center, 3rd floor

Hours: 6:30 a.m.–10:00 p.m., Mon.–Fri.; 8:00 a.m.–5:00 p.m., Sat. and Sun.

Pennsylvania Convention Center Business Center, exhibit hall level

Hours: 9:00 a.m.–5:00 p.m., Mon.–Fri.

Hours are subject to change.

CHILD CARE

A daytime child care center will operate in the Philadelphia Marriott (level 5). Children must be preregistered by 4 December.

Hours: 8:00 a.m.–6:00 p.m., 28 and 29 December; 8:00 a.m.–3:30 p.m., 30 December

DISABILITIES, FACILITIES AND SERVICES FOR PERSONS WITH

The MLA is committed to making arrangements that allow all members of the association to participate in the convention. There will be desks in the convention registration and information centers at the Pennsylvania Convention Center (Grand Hall, level 2) and the Loews Philadelphia (Millennium Hall, 2nd floor), as well as the Philadelphia Marriott (outside Grand Ballroom, Salon I, level 5), staffed with personnel who can provide assistance to convention attendees with disabilities. There will also be satellite desks in the lobbies of the Philadelphia Marriott and the Loews Philadelphia.

Hotels. Meeting rooms in the headquarters hotels and the convention center are accessible by elevator, and the doors are wide enough to accommodate wheelchairs. To reserve hotel rooms that are specifically equipped for persons with permanent or temporary disabilities, check the appropriate boxes on the convention registration form and the housing reservation form or write or call Karin Bagnall in the MLA convention office by 15 November.

Sessions. Speakers are asked to bring five copies of their papers, even in draft form, for the use of members who wish to follow the written text. Speakers who use handouts should prepare some copies in a large-print format (14- to 16-point font size). Speakers should indicate whether they

want their papers and handouts returned. Sign language interpreters and real-time captioning are available on request.

Shuttle Bus. A complimentary transportation service will be available throughout convention meeting hours to transport attendees with disabilities. Further details and phone numbers will be posted in the lobbies of the headquarters hotels.

Scooter Rentals. Scooters, for navigating the convention more easily, can be rented from ScootAround through the MLA Web site.

Karin Bagnall coordinates arrangements for persons with disabilities; she should be contacted by 15 November. She can be reached at the MLA convention office at kbagnall@mla.org; the TDD number is 646 576-5148.

EXHIBITS

Hall A, Pennsylvania Convention Center

Hours: 9:00 a.m.–6:00 p.m., 28 and 29 December; 9:00 a.m.–1:00 p.m., 30 December

Admission to the exhibit area is restricted to persons wearing badges or carrying appropriate passes. The editor of the *MLA International Bibliography* will be in the MLA exhibit booth on 28 and 29 December from 10:00 a.m. to 12:00 noon.

FRIENDS OF BILL W.

In the Philadelphia Marriott, Room 502 (level 5) is set aside for the Friends of Bill W. throughout convention hours. A list of meetings will appear in the *MLA Convention News and Program Update*, available at the convention.

GRADUATE STUDENT LOUNGE

Philadelphia Marriott (Conference Suite II, level 3)

HEADQUARTERS OFFICES

Philadelphia Marriott (Conference Suite III, level 3)

Loews Philadelphia (Hospitality Suite 413, 4th floor)

ILLNESS AND MEDICAL EMERGENCIES

Procedures may vary from one hotel to another. **Philadelphia Marriott:** dial 51 for security from any house phone and describe the situation. **Loews Philadelphia:** dial 5500 and describe the situation. **Pennsylvania Convention Center:** dial 4911 from any house phone and describe the situation. *Please note:* whether you are seeking medical advice or have a medical emergency, the hotel will direct you to the closest hospital emergency ward.

INFORMATION CENTERS

Loews Philadelphia (Millennium Hall, 2nd floor)
Pennsylvania Convention Center (Grand Hall, level 2)
Hours: 12:00 noon–9:00 p.m., 27 December
8:00 a.m.–7:00 p.m., 28 and 29 December
8:00 a.m.–1:00 p.m., 30 December

JOB INFORMATION CENTER

Pennsylvania Convention Center (Ballroom A, ballroom level)
Hours: 12:00 noon–8:00 p.m., 27 December
8:00 a.m.–8:00 p.m., 28 December
9:00 a.m.–6:00 p.m., 29 December
9:00 a.m.–12:00 noon, 30 December

LOST AND FOUND

Members wishing to report personal items either lost or found should call extension 51 for security at the Philadelphia Marriott, extension 5500 at the Loews Philadelphia, and extension 4911 at the Pennsylvania Convention Center.

LOUNGES

Loews Philadelphia (Millennium Hall, 2nd floor)
Pennsylvania Convention Center (Grand Hall, level 2)
Philadelphia Marriott (Conference Suite II, level 3; this is the graduate student lounge)

MAIL AND MESSAGES

Hotels will make every effort to deliver mail and messages received during the convention. The MLA can assume no responsibility for failure in delivery. A message service in Ballroom A, Pennsylvania Convention Center, is provided in conjunction with the Job Information Center to facilitate exchange of messages between job candidates and interviewers. For other kinds of messages, check the “Who’s Where” listing (see “Who’s Where” section) posted near the two members’ lounges, then leave messages with the desk clerk at the appropriate hotel. Bulletin boards where convention attendees may post messages for their colleagues will also be provided in the lounges.

MEETINGS

Meetings will be held in the Philadelphia Marriott (most English sessions), the Loews Philadelphia (most foreign language and comparative literature sessions), and the Pennsylvania Convention Center (some foreign language sessions, some comparative literature sessions, and some English sessions). Details on all sessions, including the Presidential Address, the Delegate Assembly, and open hearings, can be found in the Program.

MEMBERSHIP IN THE MLA

New membership dues and 2007 renewals will be accepted at the MLA registration centers in the Loews Philadelphia and Pennsylvania Convention Center. Individuals who join the association while registering for the convention are entitled to register at members’ rates.

MLA CONVENTION NEWS AND PROGRAM UPDATE

The *MLA Convention News and Program Update* will print special notices, schedule changes, and reports of convention activities. It is available free at the MLA information centers. The 27 December issue will be available on the MLA Web site in mid-December.

NEH INFORMATION

Staff members from the National Endowment for the Humanities will be available to provide materials and information about the endowment on Thursday, 28 December, from 9:00 a.m. to 1:00 p.m. and on Friday, 29 December, from 9:00 a.m. to 5:00 p.m. in the Pennsylvania Convention Center (202B).

Sonia Feigenbaum, Senior Program Officer, NEH Division of Education, will conduct a workshop at the MLA convention to discuss applying for an NEH grant. This presentation, “Getting Funded in the Humanities: An NEH Workshop,” is scheduled for 28 December from 3:15 to 5:15 p.m. in 402-403, Philadelphia Marriott. For further information see the front matter of the Program or go to www.mla.org.

PARKING

Current rates at the downtown hotels vary from approximately \$25 to \$35 per day with in-and-out privileges. Parking in garages near the hotels ranges from approximately \$7 to \$9 per hour to \$16 to \$25 per day. Parking at the Philadelphia Marriott is \$35 per day. In-and-out privileges are for overnight guests only. Parking at the Loews Philadelphia is \$32 per night with in-and-out privileges.

PASSES

A convention speaker may obtain a pass for a family member or friend who has no professional interest in language or literature to hear a paper given by that speaker. These passes are available to speakers at the MLA information centers. All MLA members and members of the profession that the MLA serves are required to register in order to participate in or attend meetings. Please note that if you need a pass for an evening session, you must obtain it before the information centers close.

MLA convention registrants may obtain free passes to the exhibit hall for guests they accompany in the hall. Persons who are not registered for the convention and who are not accompanied by registrants may purchase a one-day pass to the exhibit hall for \$10. These passes are available at the Exhibit Registration booth across from the entrance to Exhibit Hall A.

PROGRAMS

Programs are available for \$5 at the MLA information centers.

REGISTRATION

Loews Philadelphia (Millennium Hall, 2nd floor)

Pennsylvania Convention Center (Grand Hall, level 2)

Hours: 12:00 noon–9:00 p.m., 27 December
8:00 a.m.–7:00 p.m., 28 and 29 December
8:00 a.m.–1:00 p.m., 30 December

REGISTRATION REFUNDS

Requests for refunds of registration fees must be made in writing, accompanied by unused convention badges, and postmarked no later than 26 December. A \$10 service fee is deducted from all refunds. Any disputes regarding convention fees should be put in writing and sent to the Director of Convention Programs at the MLA convention office.

RESTAURANT RESERVATIONS AND INFORMATION

The Philadelphia Convention and Visitors Bureau will provide a Restaurant Reservations and Information desk near the MLA Registration and Information center located in the Pennsylvania Convention Center (Grand Hall, level 2). Staffed by knowledgeable personnel, the service offers information on restaurants, cuisine, nightlife, theater, sports, and attractions and can make complimentary dining reservations. The desks will be open on 27 December from 12:00 noon to 6:00 p.m., on 28 and 29 December from 9:00 a.m. to 6:00 p.m., and on 30 December from 9:00 a.m. to 1:00 p.m.

SHUTTLE BUS SERVICE

Because of the proximity of the headquarters hotels, there will be a shuttle service only for attendees with disabilities.

SMOKING

Pennsylvania law allows smoking in restaurants and bars; however, there is usually a designated nonsmoking area. No smoking is allowed in hotels except in designated smoking areas. Smoking is permitted in designated guest rooms. Smoking is not allowed in meeting rooms. The Pennsylvania Convention Center is a nonsmoking facility.

SOCIAL SCIENCE RESEARCH COUNCIL

Staff members from the Social Science Research Council will be available to provide materials and information about the council's fellowships on Friday, 29 December, from 10:00 a.m. to 12:00 noon and from 2:00 p.m. to 5:00 p.m. in the Pennsylvania Convention Center (202A).

SPEAKER READY ROOMS

Space in the Loews Philadelphia (P2, 3rd floor) and the Philadelphia Marriott (Meeting Room 414, level 4) has been reserved to allow speakers to run through their audiovisual presentations before their sessions. Those who have computer presentations should have completed a Presenter's Computer Information form to arrange for a pretest appointment. If you have not done so, please contact Karin Bagnall (kbagnall@mla.org).

TELEPHONES

With the increased use of cell phones, there are a limited number of public phones available in the hotels and convention center. Calls may not be made from telephones in meeting rooms, and the use of telephones in any convention office is limited to members of the MLA staff.

TRANSPORTATION TO AND IN PHILADELPHIA

MLA convention hotels are located in Center City, Philadelphia.

By plane. Philadelphia International Airport is served by all major domestic carriers, with flights to more than 100 cities, including 30 international destinations. For further information see the front matter of the Program or go to www.mla.org.

By train. Philadelphia is served by Amtrak (800 USA-RAIL; www.amtrak.com), which operates rail service along the northeast corridor. For further information see the front matter of the Program or go to www.mla.org.

By bus. Intercity bus service is excellent, with daily arrivals from all parts of the country. The Greyhound Terminal (215 931-4075) is located at 20th and Filbert Streets.

Transit. Philadelphia has an excellent transit system. The Southeastern Pennsylvania Transportation Authority (SEPTA) offers commuter rail service between the city and the suburbs. Suburban Station and Market East Station are in the heart of the business, shopping, and hotel districts. Also, 30th Street Station provides a quick connection with Amtrak. Each of these stations connects the entire rail system with the city's Airport Rail Line. SEPTA also operates a large fleet of buses, subways, and streetcars throughout the city and suburbs with highly concentrated service in the Center City area. Two subway lines—Market-Frankford (east-west) and Broad Street (north-south)—crisscross the city. Cash fare on most routes is \$2 (exact change required). Discounted tokens and passes are available. Call 215 580-7800 for specific travel instructions and sales locations. Calls are answered from 6:00 a.m. to 8:00 p.m., Monday through Friday, and from 8:00 a.m. to 6:00 p.m. on weekends.

"WHO'S WHERE"

The "Who's Where" directory will be posted in the members' lounges in the Loews Philadelphia and the Pennsylvania Convention Center and near the Job Information Center in the Pennsylvania Convention Center. The directory will include the names and convention addresses of persons who make hotel reservations through the housing bureau or send their local addresses to the MLA office before 10 December. Only hotel names or local addresses are listed. Members are advised to check their own "Who's Where" listings for accuracy and to make any necessary revisions. Most of the information used to compile the list comes from the housing service, not from the MLA.

FLOOR PLAN LOEWS PHILADELPHIA

Meeting Rooms

Adams, third floor
 Anthony, third floor
 Commonwealth Hall A–D, second floor
 Congress A–C, fourth floor
 Hospitality Suite 414, fourth floor
 Howe, thirty-third floor

Jefferson, third floor
 Lescaze, thirty-third floor
 Regency Ballroom A–C, second floor mezzanine
 Tubman, third floor
 Washington A–C, third floor

Service Areas

- ① MLA registration and information (Millennium Hall, second floor)
- ② MLA headquarters office (Hospitality Suite 413, fourth floor)
- ③ Members' lounge and "Who's Where" directory (Millennium Hall, second floor)
- ④ Desk for persons with disabilities (Millennium Hall, second floor)
- ⑤ Speaker ready room (P2, third floor)

Second Floor

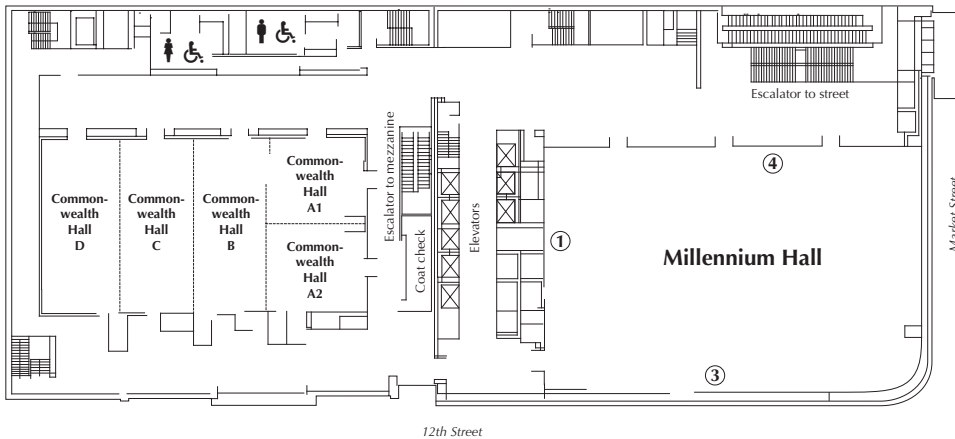

Second Floor Mezzanine

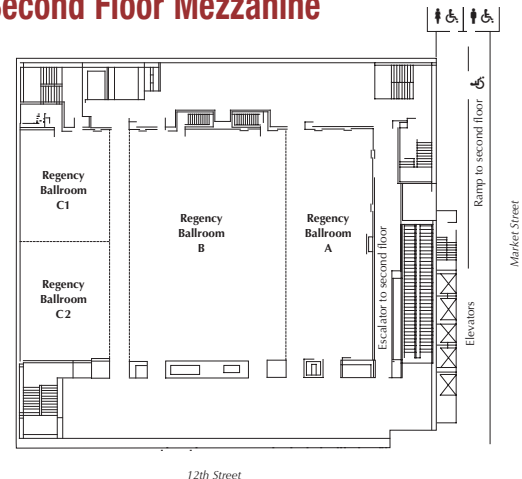

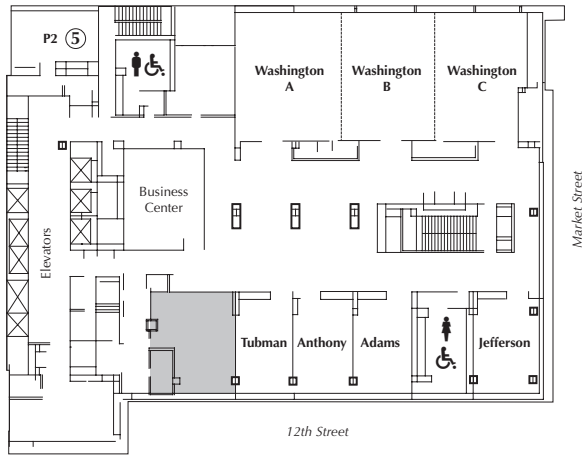

Third Floor

Fourth Floor

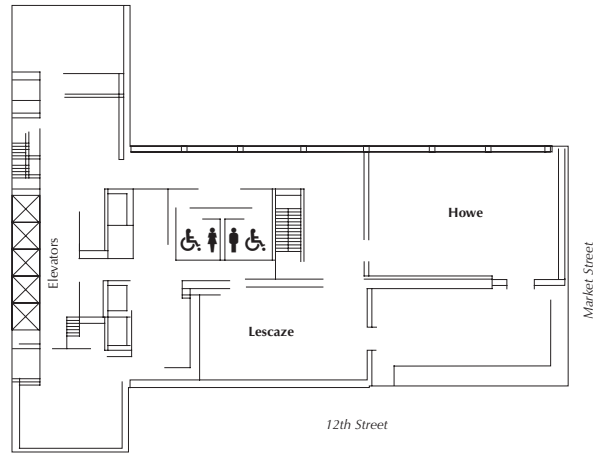
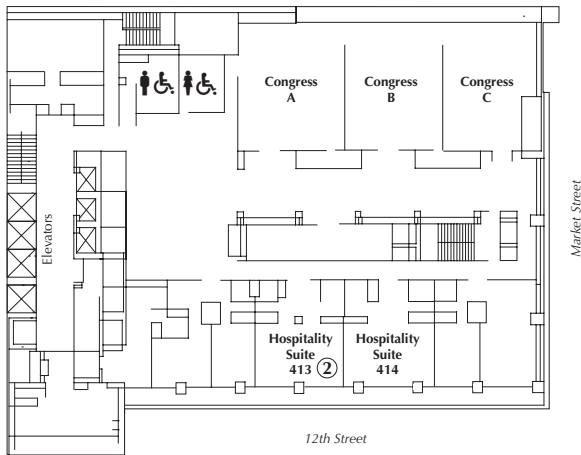

Thirty-Third Floor

PENNSYLVANIA CONVENTION CENTER

Level 1

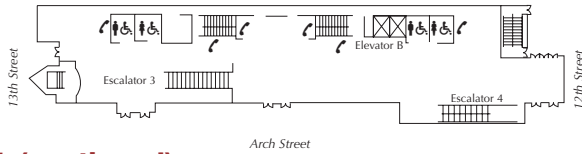

Level 1 (continued)

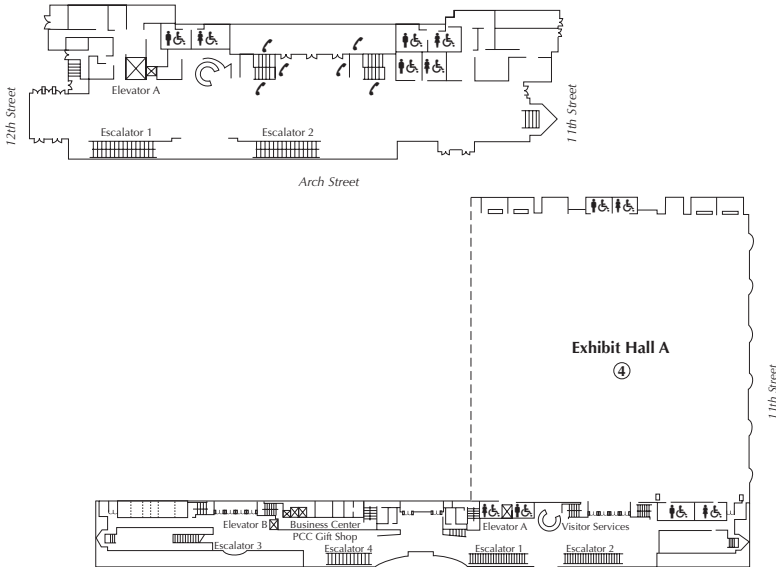

Level 2 and Exhibit Hall

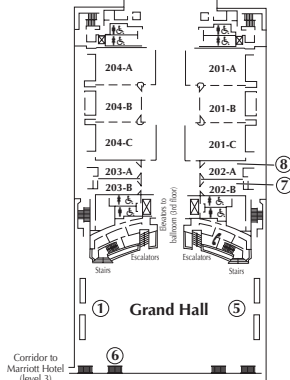

Ballroom Level

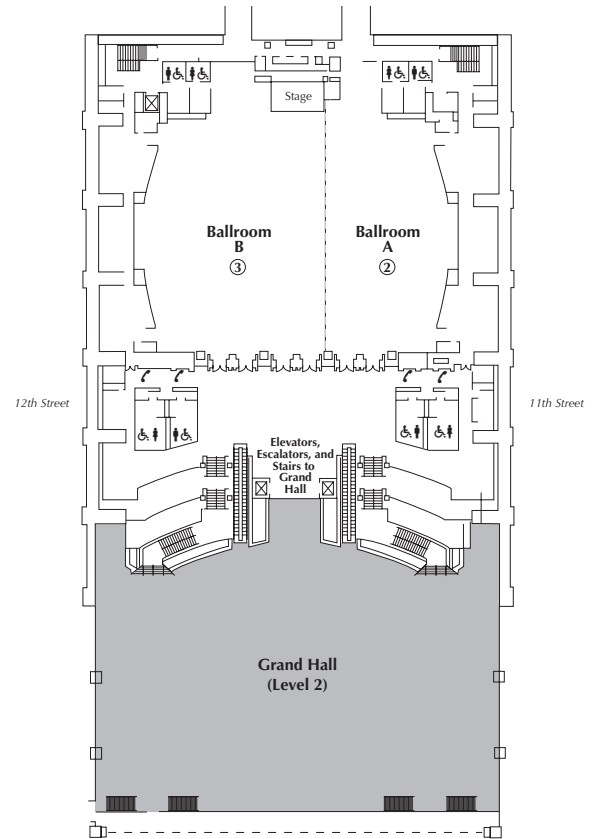

Meeting Rooms

- 201-A-C, level 2
- 202-A and B, level 2
- 203-A and B, level 2
- 204-A-C, level 2

Service Areas

- ① MLA registration and information (Grand Hall, level 2)
- ② Job Information Service (Ballroom A, Ballroom level)
- ③ Interview area (Ballroom B, Ballroom level)
- ④ Exhibit Hall A, level 2
- ⑤ Members' lounge and "Who's Where" directory (Grand Hall, level 2)
- ⑥ Desk for persons with disabilities (Grand Hall, level 2)
- ⑦ NEH (202B, level 2— 28–29 December only)
- ⑧ Social Service Research Council (202A, level 2— 29 December only)

PHILADELPHIA MARRIOTT HOTEL

Meeting Rooms

- Grand Ballroom, Salons E-L, level 5
- Independence Meeting Room Salons I-III, level 2
- Liberty Ballroom Salons A-C, level 2
- Meeting Rooms 302-310, level 3
- Meeting Rooms 401-413, level 4

Service Areas

- ① MLA headquarters office (Conference Suite III, level 3)
- ② Child care registration (Grand Ballroom, Salons A-D, level 5)
- ③ Desk for persons with disabilities (outside Grand Ballroom, Salon I, level 5)
- ④ Friends of Bill W. (Meeting Room 502, level 5)
- ⑤ Graduate student lounge (Conference Suite II, level 3)
- ⑥ Press room (Meeting Room 301, level 3)
- ⑦ Speaker ready room (Meeting Room 414, level 4)

Level 3 (connects to level 2 by bridge)

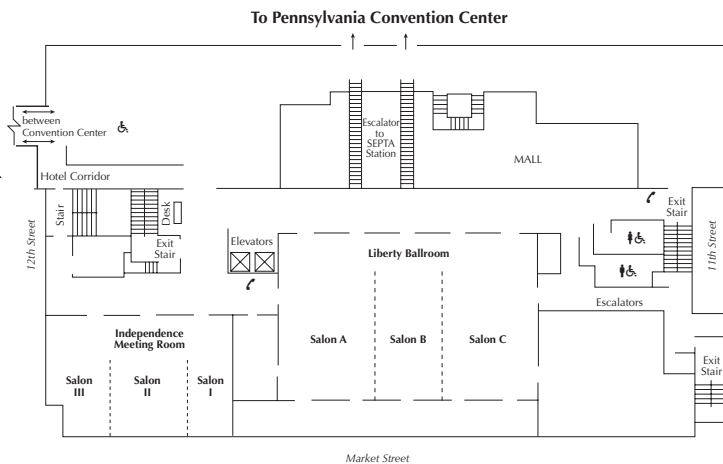
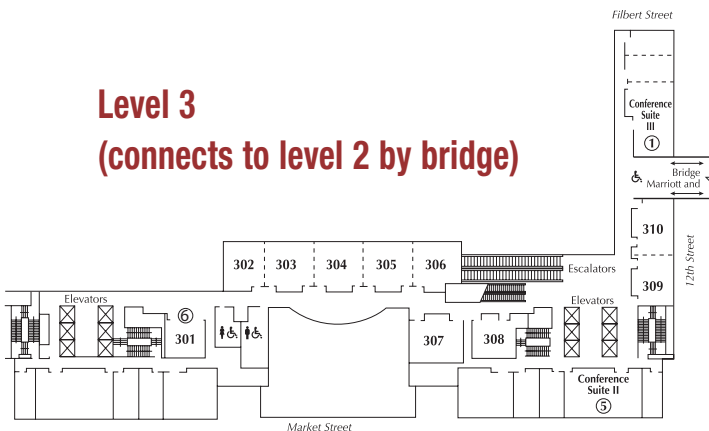

Level 4

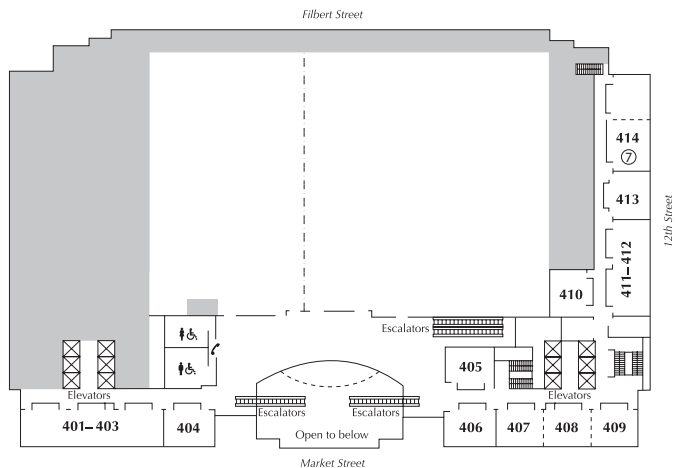

Level 5

